

Proposed
Sustainability &
Enterprise Centre
&
School of Health

Sustainability &
Enterprise Centre

A new four-storey development at the centre of the University campus. The building will house teaching facilities, office accommodation and short / long term incubator units for start up business.

At the heart of the scheme is the ambition to create an ultra low energy and highly sustainable building that will incorporate innovative materials, sustainable technologies and ecological enhancements.

The ambition is to achieve the highest category of 'outstanding' using BREEAM (The Building Research Establishment Environmental Assessment Method; the leading and most widely used environmental assessment method for buildings).

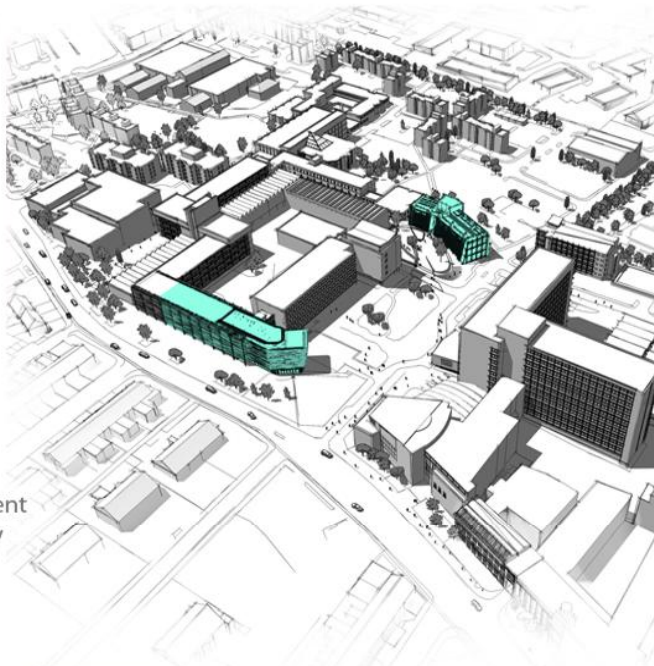

School of Health

The University of Bradford's aim is to relocate the School of Health from its existing accommodation off site, on to their central campus.

This involves the refurbishment of four floors of office accommodation and a five-storey extension providing modern teaching facilities. By utilising vacant accommodation within Horton A Building and the addition of a state-of-the-art extension, the aim is to take a sustainable approach to development, whilst achieving a prominent gateway building to the University campus.

The proposals are a significant part of the wider campus improvements and form part of the University's aspiration for its future as an Ecoversity.

We would invite comments from anyone who feels they would be affected by these proposals in order to incorporate genuine concerns into the designs. **Please either join us for a brief presentation followed by an opportunity to comment at 6.00pm on 7th December at the Grange Interlink Community Centre, Summerville Road.** Or write to us by the 5th December. Please contact: PSK at Batley Business Centre, 513 Bradford Road, Batley, West Yorkshire, WF17 8LL or email Stacey@psk-pt.co.uk

